

# Guajome Park Academy-Traffic Route

Dated: 3 Feb 2006

## STUDENT DROP-OFF

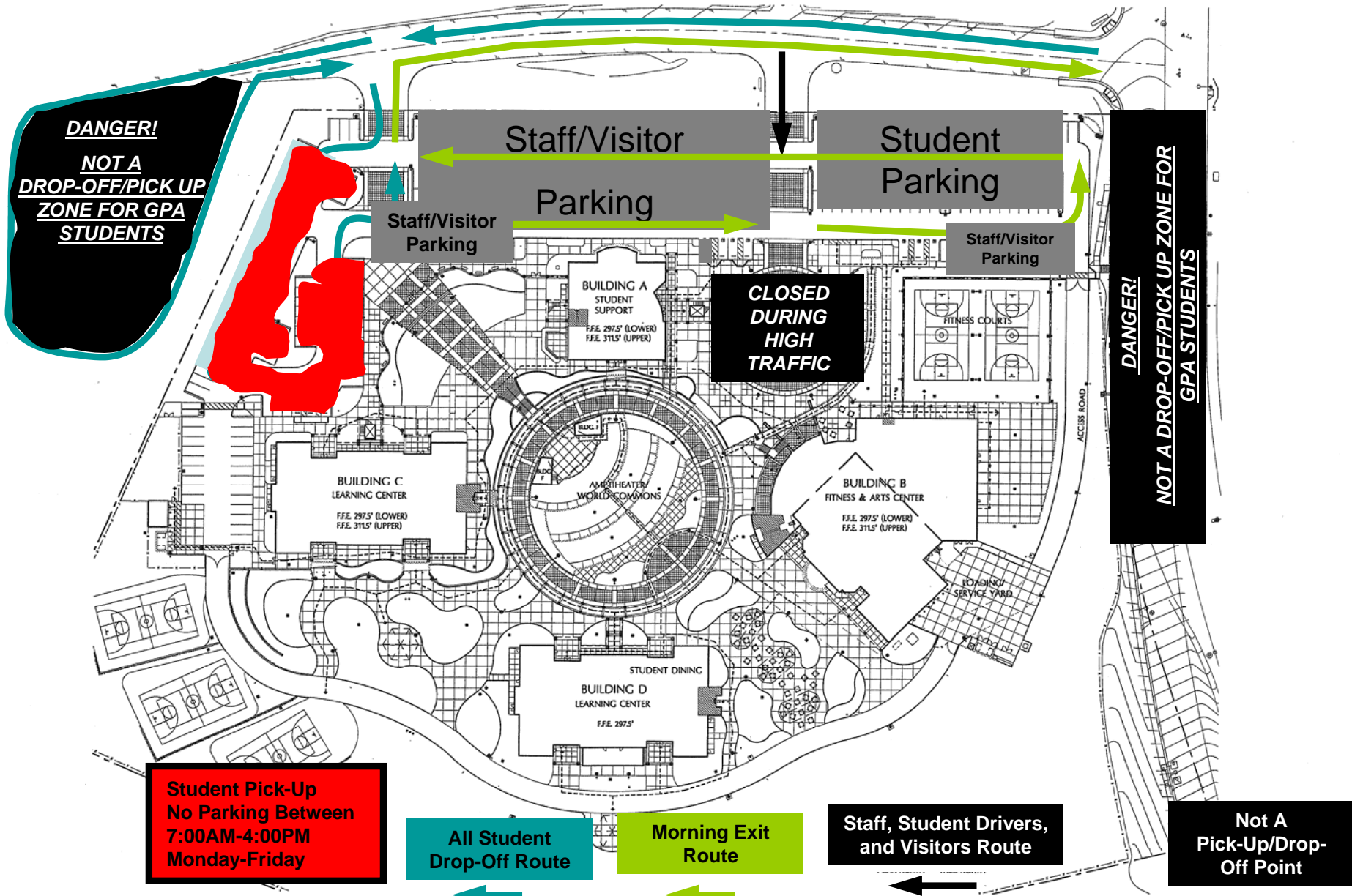

# Guajome Park Academy-Traffic Route

Dated: 3 Feb 2006

## STUDENT PICK-UP

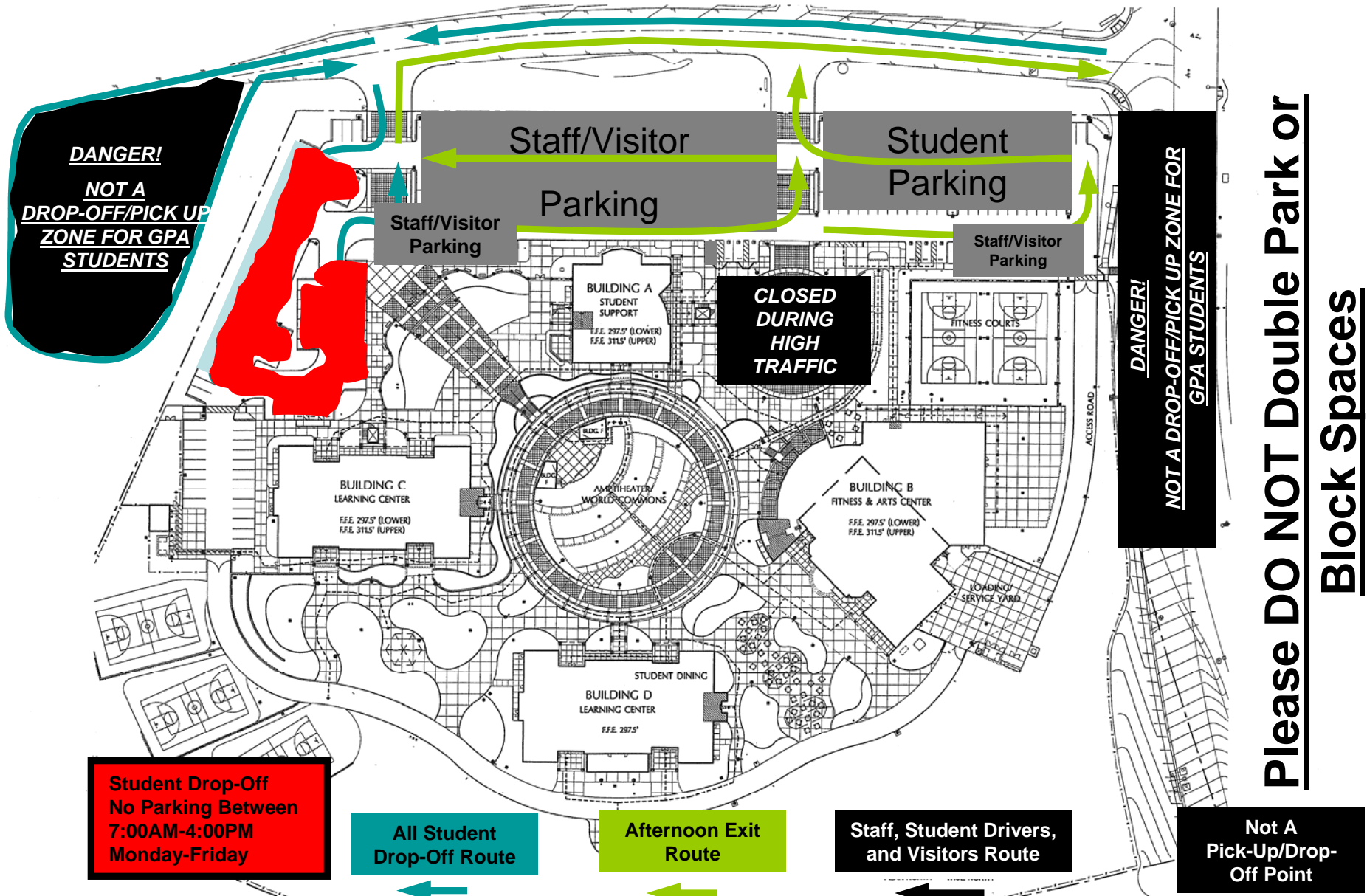

**DANGER!**  
**NOT A**  
**DROP-OFF/PICK UP**  
**ZONE FOR GPA**  
**STUDENTS**

**CLOSED**  
**DURING**  
**HIGH**  
**TRAFFIC**

**DANGER!**  
**NOT A DROP-OFF/PICK UP ZONE FOR**  
**GPA STUDENTS**

**Please DO NOT Double Park or**  
**Block Spaces**

**Student Drop-Off**  
**No Parking Between**  
**7:00AM-4:00PM**  
**Monday-Friday**

**All Student**  
**Drop-Off Route**

**Afternoon Exit**  
**Route**

**Staff, Student Drivers,**  
**and Visitors Route**

**Not A**  
**Pick-Up/Drop-Off Point**